

REVISION	DATE	DESCRIPTION	NO.	BY

GATES ARCHITECTURAL DESIGN INC.



P.O. BOX 8533
 132 LANDING ROAD
 LANDING NEW JERSEY 07850
 (973) 398 - 4860
 (732) 793 - 8600

This drawing and its contents remain the property of the Architect and can not be used or reproduced without the expressed written permission of the Architect.

PROJECT
SOCIETY HILL AT PISCATAWAY
 NEW MAINTENANCE BUILDING AT
 SOCIETY HILL
 550 CHESTERFIELD DRIVE
 PISCATAWAY, NEW JERSEY

DATE: 9-26-15
 SCALE: 3/16"=1'-0"
 DRAWN BY: DAB
 CHECKED BY: JAG

© 2015 GATES ARCHITECTURAL DESIGN, INC.

JOSEPH A. GATES, N.J. LICENSE NO. 12124
 JOSEPH A. GATES, PA. LICENSE NO. RA-014263-B
 This drawing not valid for building permits unless signed and sealed by the Architect.

DRAWING TITLE
ELECTRICAL PLANS
 CDN 12033101 SHEET E-1
 12033 OF
 PROJECT NO.

ELECTRICAL SYMBOLS LEGEND

- HOME RUN TO PANEL. PHASE, NEUTRAL AND GROUND CONDUCTORS INDICATED. ALL CONDUCTORS SHALL BE #12 MINIMUM OR AS NOTED IN THE PANEL SCHEDULES
- 20 AMP DUPLEX RECEPTACLE, +18" TO CENTERLINE OF MOUNTING BOX OR AS NOTED, COORDINATE FINAL LOCATIONS WITH CLIENT AS APPLICABLE
- GROUND FAULT RECEPTACLE, +18" TO CENTERLINE OF MOUNTING BOX OR AS NOTED, COORDINATE FINAL LOCATIONS WITH CLIENT AS APPLICABLE
- DOUBLE DUPLEX (QUAD) RECEPTACLE, +18" TO CENTERLINE OF MOUNTING BOX OR AS NOTED, COORDINATE FINAL LOCATIONS WITH CLIENT AS APPLICABLE
- DISCONNECT SWITCH (FURNISHED AND INSTALLED BY ELECTRICAL CONTRACTOR, UNLESS OTHERWISE NOTED)
- MOTOR CONNECTION
- PANELBOARD
- WEATHERPROOF
- HEIGHT ABOVE FLOOR TO CENTER LINE OF MOUNTING BOX, XX" AS NOTED
- SINGLE POLE SWITCH, +46" TO CENTERLINE OF MOUNTING BOX
- 3-WAY SWITCH, +46" TO CENTERLINE OF MOUNTING BOX

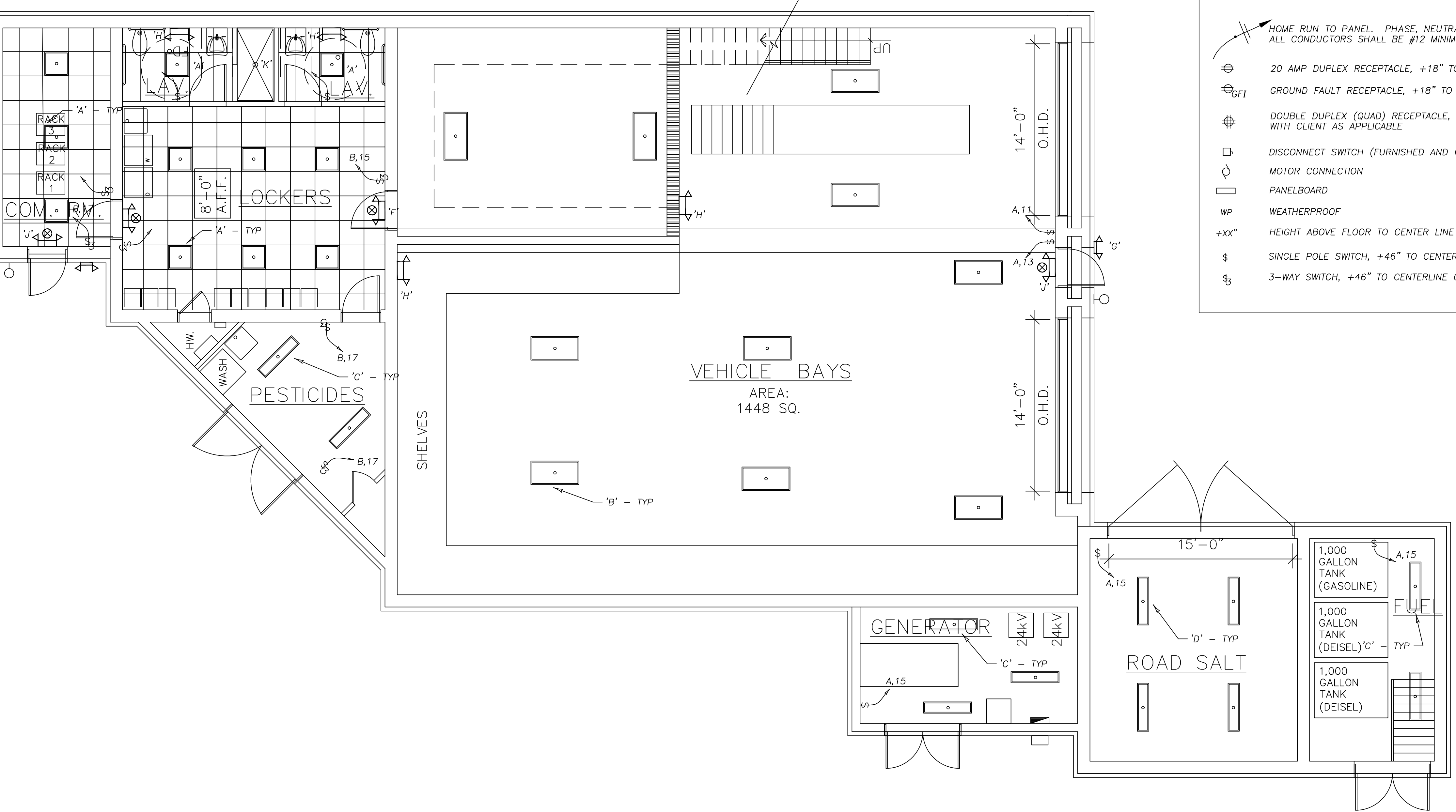

FIRST FLOOR PLAN

PRO-ENERGY DESIGN
 207 North Main Street
 MANVILLE, NJ 08835
 OFFICE # (908) 231-8679 FAX # (908) 428-9421

Philip A. LaBue, Jr., P.E.
 NJ PROFESSIONAL ENGINEER 26265
 NJ C.O.A. 24GA28157800

DRAWN BY: APS
CHECKED BY: PAL
PROJECT NO. 15057